

PCD 3fl Countersink Integral Pilot (mm)

Body Diameter (+/-0.76)	Pilot Diameter (-0.025)	CSK Angle (+/-0.5)	Thread shank	cat# 100°	cat# 130°
10	3.00	100/130	M6x1.0	CIP3010300	CIP3210300
12	3.00	100/130	M6x1.0	CIP3012300	CIP3212300
14	3.00	100/130	M8x1.0	CIP3014300	CIP3214300
17	4.00	100/130	M8x1.0	CIP3017400	CIP3217400
19	6.00	100/130	M8x1.0	CIP3019600	CIP3219600
22	8.00	100/130	M8x1.0	CIP3022800	CIP3222800
25	8.00	100/130	M8x1.0	CIP3025800	CIP3225800

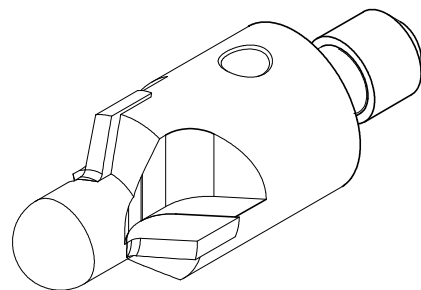

**PCD C'sink
With Integral Pilot**



Materials:

Steel ; PCD

CAT. NO.

By Table

SCALE: NTS

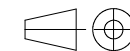

Unless specified
Tolerances are in
Accordance with:
DIN ISO 2768-m

This drawing is
The property of
TELCON DIAMOND
And may only be
Copied or passed
To a third party
With our permission.