

PCD straight FL End-mill (Inch)

Cutting Diameter (-.002)	Shank Diameter (h6)	LOC (min)	OAL (+.06)	# of flutes	Cat#
1/8	1/8	1/4	2	1	FOPM125125I
3/16	3/16	5/16	2	1	FOPM188188I
1/4	1/4	3/8	2	2	FOPM250250I
3/8	3/8	1/2	2.5	2	FOPM375375I
1/2	1/2	5/8	3	2	FOPM500500I
5/8	5/8	3/4	3.25	2	FOPM625625I

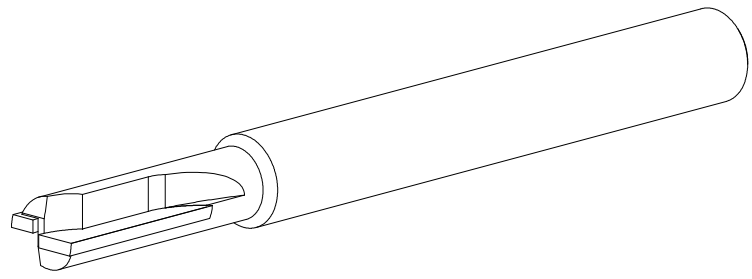

PCD EndMill Straight Flute		
Materials: Carbide ; PCD	SCALE: NTS 	This drawing is The property of TELCON DIAMOND And may only be Copied or passed To a third party With our permission.
CAT. NO.	Unless specified Tolerances are in Accordance with: DIN ISO 2768-m	
By Table		